

UL Listed*

Annunciators
4601 Series Hard-Wired
Remote Control and LED Annunciation

FEATURES

- **Modular design, select remote control and/or LED annunciation as required**
- **Compatible with Simplex models 4004 and 4005 fire alarm control panels**
- **System control module provides:**
 - Yellow system status LEDs for supervisory, trouble, and alarm silence
 - Acknowledge switch for alarm, supervisory, or trouble conditions
 - Alarm silence switch for silencing audible notification appliances
 - System reset switch
 - Built-in tone-alert
 - Key switch for enable/disable of system control switches
- **Multi-application red LED annunciator module provides four locations with labeling provisions**
- **Red trim plates for 2, 3, or 4-gang sizes**
- **UL listed to Standard 864**

DESCRIPTION

When used with the Simplex 4004 Fire Alarm Control Panel, these annunciators provide a remote LED status display of Alarm, Supervisory, and Trouble conditions with local tone-alert operation. Additionally, the key switch enables control of Silence, Acknowledge, and Reset. The four LED alarm annunciator module is compatible with the Simplex models 4004 and 4005 fire alarm control panels as well as most LED drive circuits that share a common +24 VDC.

Modules mount into standard 1 1/2" deep gangable switch boxes with plates available for 2, 3, or 4-gang applications. Refer to selection chart on page 2.

SPECIFICATIONS

Input Voltage	18-32 VDC, nominal 24 VDC
LED Current	10 mA @ 24 VDC, per LED
Tone-Alert Current	30 mA @ 24 VDC
Control Switch Rating	1 A maximum @ 18-32 VDC
Mounting Plates	Red with white lettering
Electrical Box Requirements (boxes by others)	Standard multi-gang switch boxes, 1 1/2" (38 mm) deep
Wiring Terminations	Terminal blocks, 22 to 16 AWG
Operating Temperature Range	32° to 120° F (0° to 49° C)
Operating Humidity Range	Up to 95% RH, non-condensing @ 95° F (35° C)

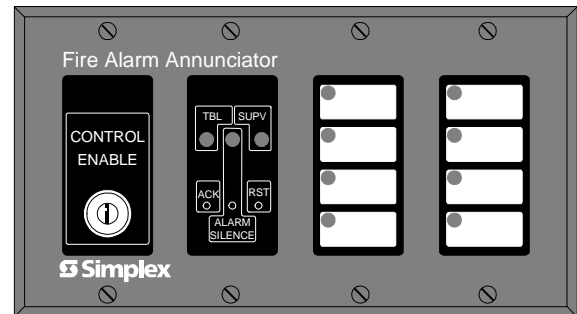

Four-Gang Plate Assembly

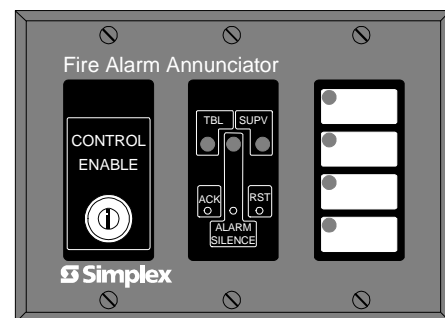

Three-Gang Plate Assembly

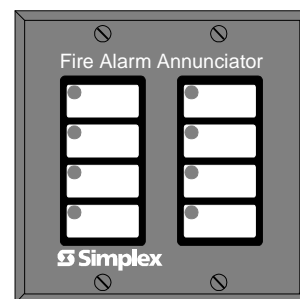

Dual-Gang Plate Assembly

* This product was not ULC listed or approved by FM, MEA (NYC), or CSFM as of document revision date. Additional listings may be applicable, contact Simplex for the latest status.

4601 SERIES ANNUNCIATOR PRODUCT INFORMATION

Selection Chart

Model	Description	Compatibility
4601-9104	Single-gang, four LED annunciator module with labels for local zone identification	Compatible with most LED drive circuits, 10 mA at 24 VDC, each LED
4601-9106	System status LEDs, control switch module, and tone-alert, requires 2-gang space	Model 4004 Fire Alarm Control Panel with 4004-9808 Annunciator Interface Module
4601-9150	Single-gang, blank filler module (black)	Select to match module choice
4601-9151	Dual-gang cover plate, red	
4601-9152	Three-gang cover plate, red	
4601-9153	Four-gang cover plate, red	

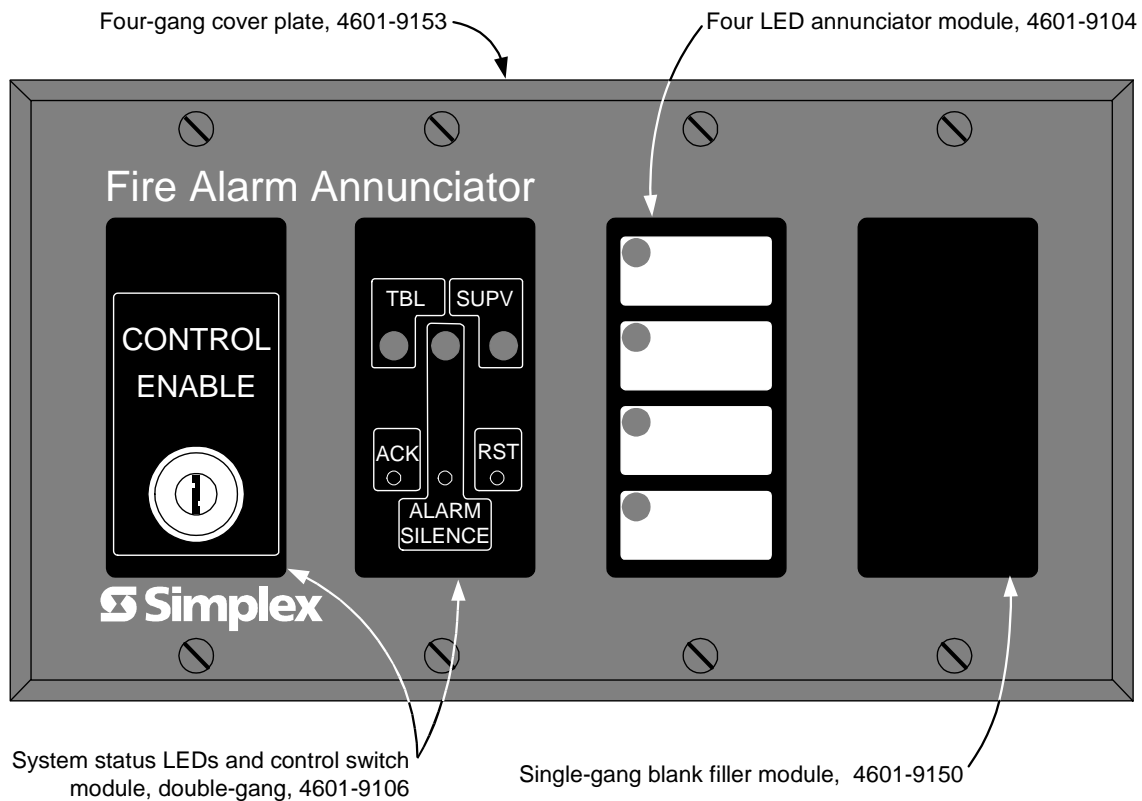

Simplex and the Simplex logo are either trademarks or registered trademarks of Simplex Time Recorder Co. in the U.S. and/or other countries.

S4601-0002-1 7/00

Simplex

Westminster, Massachusetts 01441-0001 U. S. A.
Offices and Representatives Throughout the World
Visit us on the world wide web at www.simplexnet.com

All specifications and other information shown were current as of printing and are subject to change without notice.