

Features

Compatible with ES Network (ES Net)

Network Display Unit (NDU) provides annunciation for up to 12,000 network points:

- The basic Network Display Unit (NDU) includes an ES Net network interface card and functions as a special purpose master controller dedicated to providing annunciation of up to 12,000 network points
- An NDU with a Voice Command Center (VCC) mounted in the same cabinet provides an additional separate Network node with the full capability of a 4100ES fire alarm control unit including the ability to operate as the Network Voice Command Center

NDU master controller equipment (top bay):

- Master controller assembly with operator interface
- CPU with dual configuration programs, convenient service port access, and capacity for up to 12,000 points
- ES power supply (ES-PS) and charger (9.5 A total, 12.7 A when using optional fan module 4100-5131) with on-board alarm relay and programmable auxiliary power output
- Models available with Color ES Touch Screen Display, Monochrome 2 line x 40 Character Display, or Monochrome InfoAlarm Display
- Construction that is optimized for easy installation, upgrade, and maintenance
- Glass door (ordered separately) provides view of available operator controls visible behind locked door

Standard addressable interfaces include:

- Remote annunciator module support via RUI (remote unit interface) communications port

NDU option modules include:

- DACT and City Connection
- Service modems for remote panel status inquiry
- RS-232 ports for printers or maintenance terminals
- Alarm relays and expansion power supplies
- Remote Unit Interface
- 24 Point I/O
- Fiber Optic Modems
- Physical Bridge
- BACpac Ethernet Interface
- SafeLINC Internet Interface
- Master Clock Interface

VCC equipment (second expansion bay)

- VCC includes ES Power Supply (ES-PS) and battery charger (9.5 A total, up to 12.7A when using optional fan module 4100-5131) with programmable function auxiliary power output
- For additional information on supported 4100ES basic panel features and specifications refer to data sheet S4100-1031
- Voice control options are similar to a networked fire alarm control unit with an extensive list of modules available for initiating, notification, and user interface; refer to data sheet S4100-1034 for details

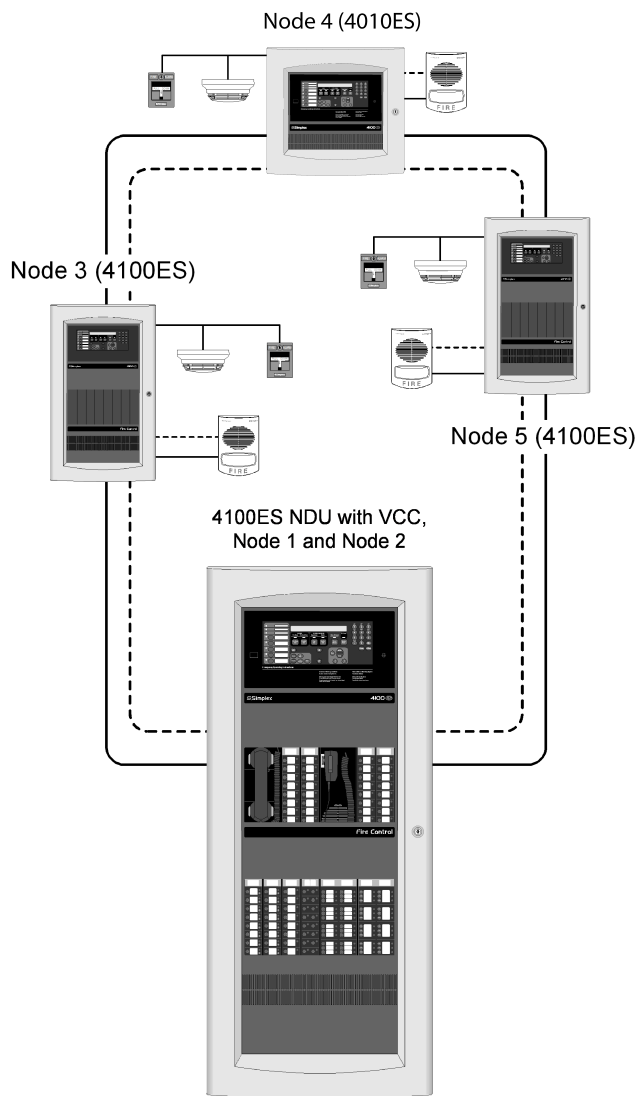

Figure 1: Network one-line diagram showing an NDU with VCC

Listings information*:

- UL 864, Fire Detection and Control (UOJZ), Smoke Control Service (UUKL), Releasing Device Service (SYZV), Emergency Communication and Relocation Equipment (UOQY)
- UL 1076, Proprietary Alarm Units - Burglar (APOU)
- UL 2017, Process Management Equipment (QVAX), Emergency Alarm System Control Units (FSZI)
- UL 1730, Smoke Detector Monitor (UULH)
- UL 2572, Mass Notification Systems (PGWM)
- CAN/ULC-S527 Control Units for Fire Alarm Systems (UOJZ7), Releasing Device Service (SYZV7)
- CAN/ULC-S559 Central Station Fire Alarm System Units (DAYR7)
- ULC/ORD-C1076 Proprietary Burglar Alarm Units and Systems (APOU7)
- ULC/ORD-C100 Smoke Control System Equipment (UUKL7)

* This product has been approved by the California State Fire Marshal (CSFM) pursuant to Section 13144.1 of the California Health and Safety Code. See CSFM Listing 7165-0026:0251 for allowable values and/or conditions concerning material presented in this document. Additional listings may be applicable; contact your local Simplex product supplier for the latest status. Listings and approvals under Simplex Time Recorder Co. are the property of Tyco Fire Protection Products.

Software Feature Summary:

- Selectable service override allows authorized operators to clear alarm conditions during system reset even if status has gone to trouble before reset occurred
- Duplicate address error detection
- Convenient PC programming using a Microsoft Windows user interface based program

Introduction

The 4100ES NDU with VCC for ES Net is a network level annunciator and manual system/point controller with optional network voice control equipment. It provides alphanumeric annunciation for up to 12,000 Network points and/or point lists and can be programmed to function as the network master controller for Alarm Silence, Trouble Acknowledge, and System Reset.

ES Net Network Overview

When connected to other ES Net network nodes, individual fire alarm control units become components of a distributed intelligence system. Each panel that directly connects to the ES network is called a network "node" and is capable of performing individual supervision and control on its locally connected devices but has the ability to inform the 4100ES NDU (as well as other network control panels) of point status and panel condition. This allows system information to reach the proper location for appropriate system response.

Multiple 4100ES NDUs (separately packaged) can be connected to an ES network to duplicate common information at separate locations, or direct selected information by type such as troubles, alarms, control, etc.

NDU Module Bay Description

The NDU Master Controller Bay (top) includes a special purpose ES power supply with battery charger (ES-PS), the master controller board, an ES network interface card, expansion space for optional features and operator interface equipment similar to that used on the standard fire alarm control modules.

The Optional NDU VCC includes an expansion bay with separate master controller board, ES network interface card, expansion space for optional features and an ES-PS power supply. This results in two separate network nodes residing within the same cabinet.

Optional LED/switch modules can also be mounted in the VCC bay. For 2-bay cabinets, the VCC mounts in bay 2. For 3-bay cabinets as shown to the right, the VCC mounts in the second expansion bay, bay 3.

The Battery Compartment (bottom) accepts two batteries, up to 50 Ah, to be mounted within the cabinet without interfering with module space.

Refer to the NDU with VCC internal module bay reference illustration for typical three bay cabinet module location.

Packaging Availability

- Modules are power-limited (unless specifically noted otherwise)
- Enclosure are available for one, two, or three bay sizes or for cabinet rack mounting
- Additional cabinets can be mounted close-nipped for module expansion
- NEMA 1/IP30 boxes, doors with tempered glass inserts, and dress panels are available in platinum or red, (ordered separately)
- Refer to data sheet **S4100-0037** for enclosure details.

Operator Interface Detail Reference

4100ES Fire Alarm Control Units are provided with either an enhanced Color ES Touch Screen Display or a basic Monochrome 2 Line by 40 Character operator interface depending on the model selected (*for information on Monochrome InfoAlarm display, refer to data sheet S4100-1045*). The following illustrations highlight the primary functions of each.

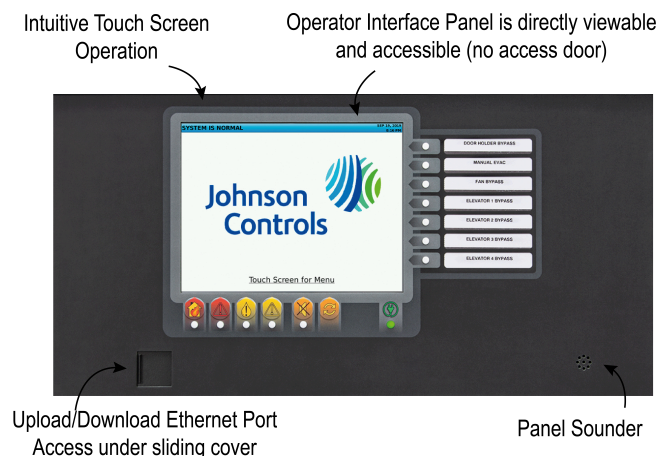

Figure 2: ES Touch Screen Display Interface

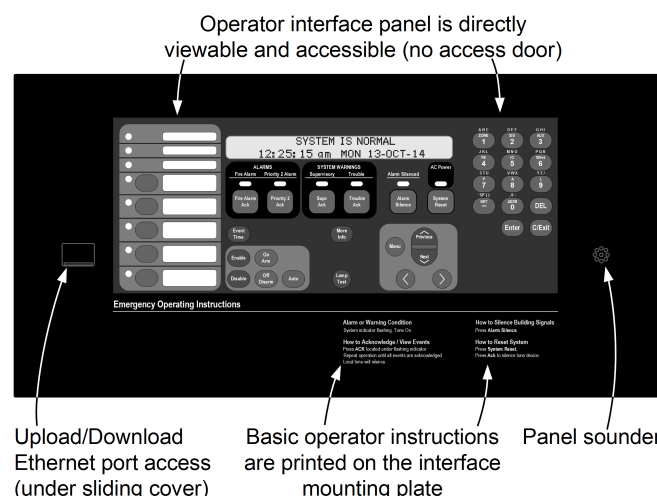

Figure 3: Monochrome 2 Line x 40 Character Display

Color ES Touch Screen Display

The Color ES Touch Screen Display interface offers intuitive operation similar to a tablet or smart phone. With a larger area format versus an individual text line display, more information is available at a glance, and minimal key presses are needed to access detailed information.

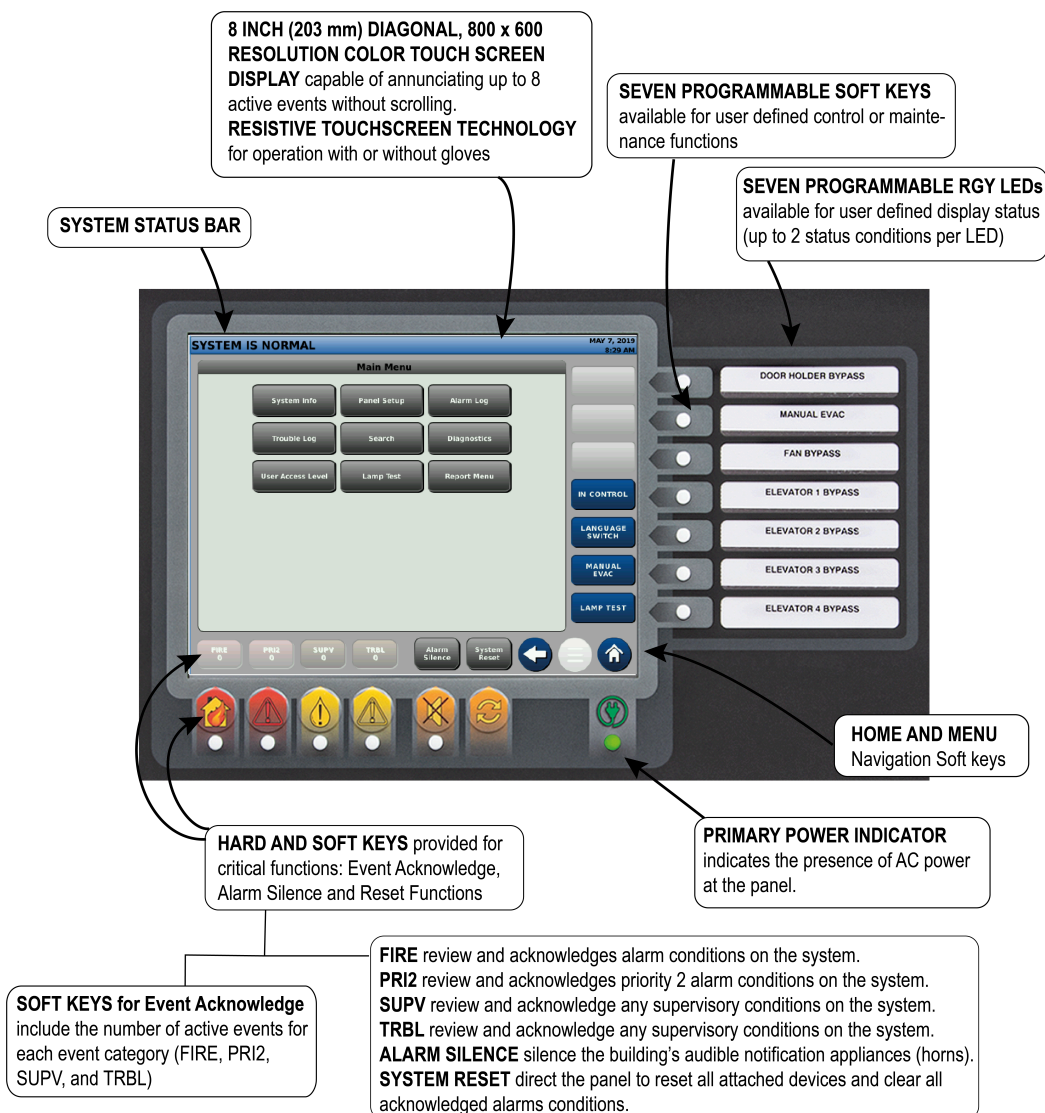

Figure 4: ES Touch Screen Display Operator Interface

Features

ES Touch Screen Displays provide customized operating experience

- Event activity display choices include: First 8 Events; or First 7 Events with emphasis on Most Recent; or First 6 Events with emphasis on First and Most Recent (individually selectable for each event type)
- System reports are easily viewable; logs can be read with minimal scrolling
- Up to two languages are available per system, easily selected by programmable key press
- Information sent to Remote ES Touch Screen Displays can be vectored by point or zone
- Both Hard and Soft keys available for critical functions: Event Acknowledge, Alarm Silence, and Reset Functions
- Resistive touchscreen technology allows operation with or without gloves
- Seven programmable RGY LEDs available for user-defined display status (up to 2 status conditions per LED)
- Seven programmable Soft keys available for user-defined control or maintenance functions
- PRI2 Soft key label can be changed to CO to annunciate Carbon Monoxide detection status
- ES Touch Screen Display can be programmed to report individual points or groups of points as a single zone
- Supports ability to display a custom watermark background file of a company logo or other desired display content
- Seismically compliant under the State of California Statewide Office of Housing and Development (OSHPD) Special Seismic Certification (SSC) program guidelines. Refer to *Simplex Seismic Application Guide* 579-1213 and *Battery Brackets for Seismic Activity Applications* S2081-0019 for details.

Display properties

- 8 inch (203 mm) diagonal, 800 x 600 resolution color touch screen display capable of annunciating up to 8 active events without scrolling
- Bright white LED backlighting provides efficient and long lasting illumination; backlight is dim in quiescent state, automatically switches to full power on touch or on event activity in system.

Description

ES Touch Screen Displays for 4100ES fire alarm systems provide a large display with extended information content, dual language support including UTF-8 character languages, and an intuitive control key interface per the following:

- Up to 10 ES Touch Screen Displays are supported per 4100ES control panel; able to allow one ES Touch Screen Display to take-control and to designate access levels for interfaces not in-control; programmable LEDs can be assigned to in-control status indications
- Menu-driven format conveniently prompts operators for the next action required
- Direct point callup displays individual points alphabetically and then homes in on the logical choice as more point information is entered
- Event categories are color coded for quick visual representation; Red for Alarm and Priority 2 Events; Yellow for Supervisory and Trouble events
- Date formats are either MM/DD/YY or DD/MM/YY
- Time formats are either 24 hour or 12 hour with AM/PM
- System Normal screen supports a color background (watermark) for company name, company logo, or other desired display content

Example Display Screens

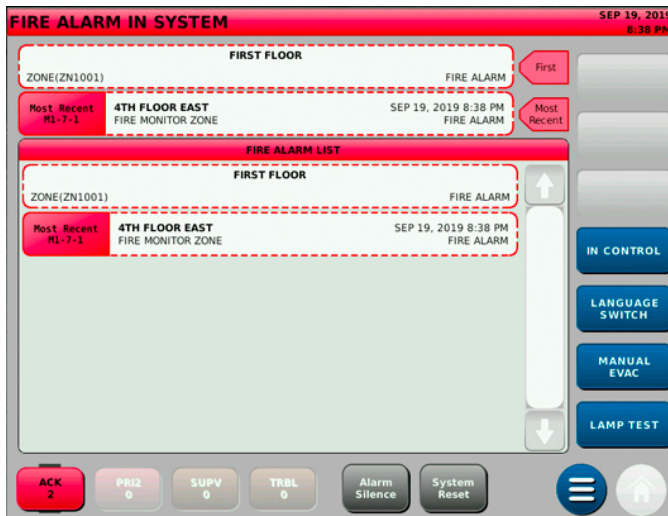

Figure 5: First and Most Recent Alarm Display



Figure 6: Main Menu



Figure 7: First Eight Active Trouble Events List

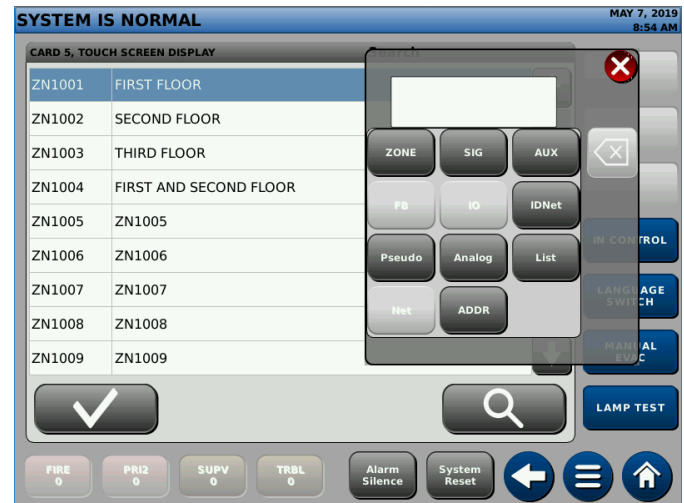

Figure 8: Direct Point Callup

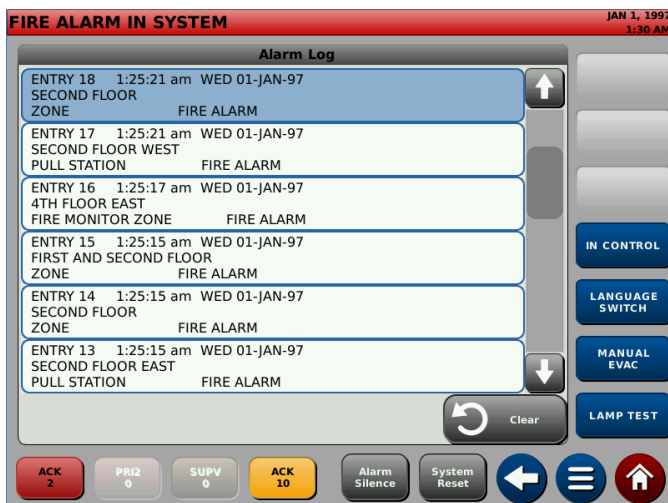

Figure 9: Alarm History Log

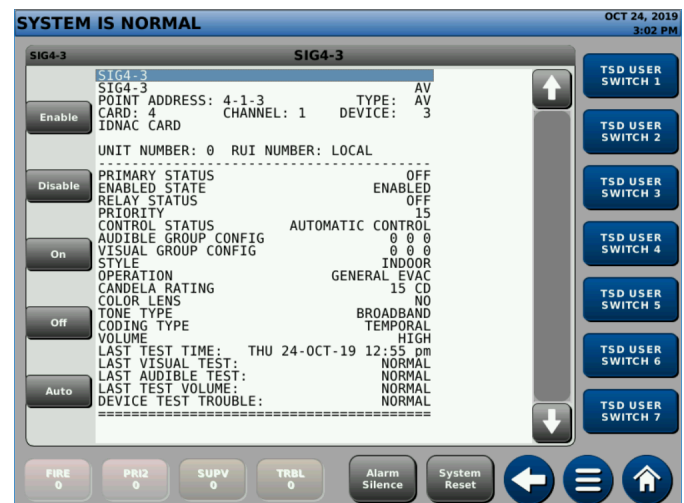

Figure 10: Detailed Point Status Screen for TrueAlert ES Appliance

Specifications

Table 1: General ES Touch Screen Display Specifications

| Specification | Rating |
|--|--|
| Resolution | 800 x 600 Pixels (RGB) |
| Size / Type | 8 inch (203 mm) Diagonal / Color Touch Screen |
| Touch Screen Technology | Resistive |
| Event Display | Up to 8 Events without scrolling |
| Normal Screen Custom Watermark File Format | 680 x 484 Pixels: BMP, JPG, TIFF, GIF or PNG file format |
| Environmental | Operating Temperature: 32°F to 120°F (0°C to 49°C) |
| | Operating Humidity: Up to 93% RH, non-condensing @ 90°F (32°C) maximum |

Operator Interface with Monochrome 2 x 40 LCD

- Convenient and extensive operator information is provided using a logical, menu-driven display
- Multiple automatic and manual diagnostics for maintenance reduction
- Alarm and Trouble History Logs (up to 1250 entries for each, 2500 total events) are available for viewing from the LCD, or capable of being printed to a connected printer, or downloaded to a service computer
- Convenient PC programmer label editing
- Password access control

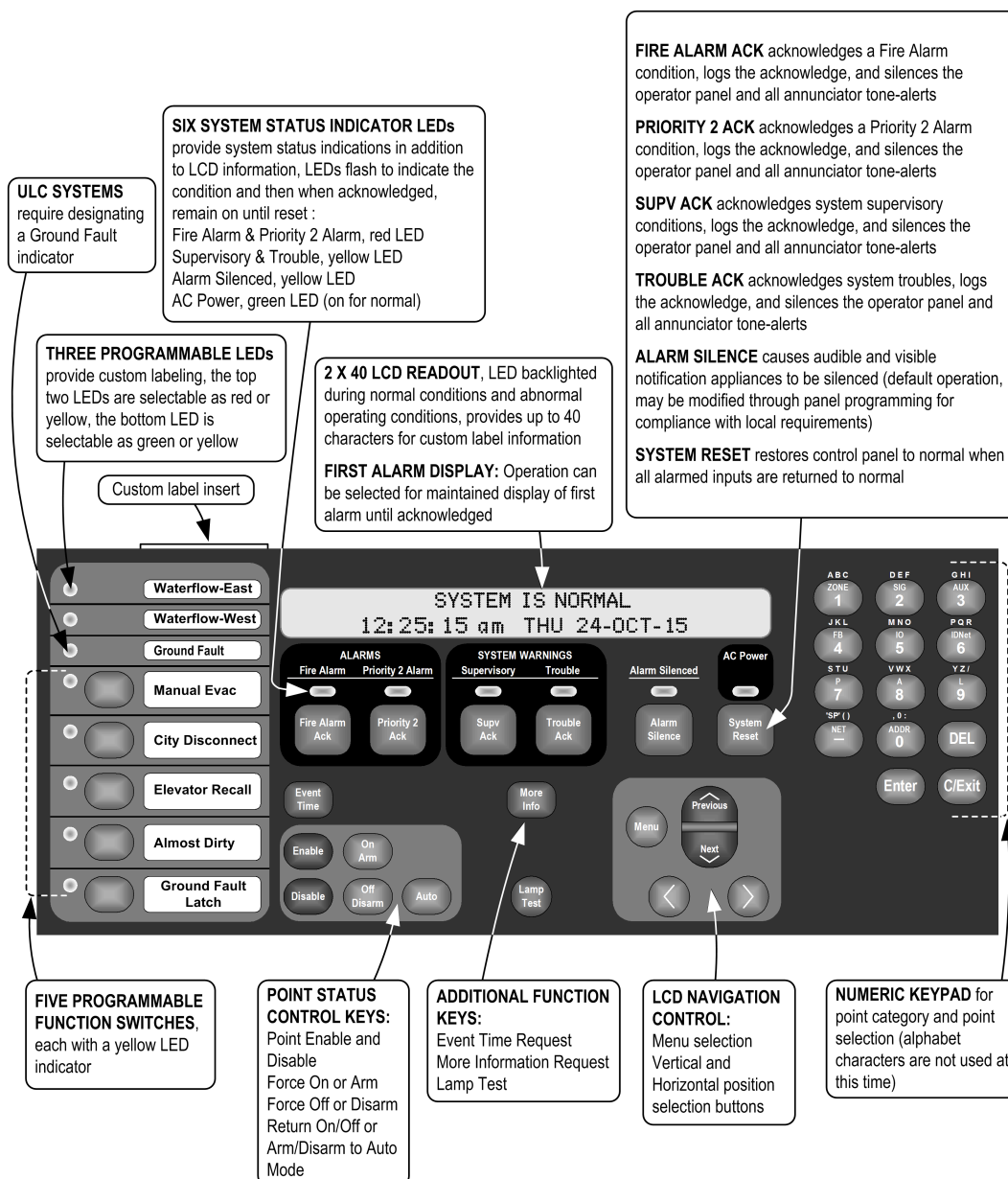

Figure 11: Operator Interface Features

Standard Module Details

NDU (top bay) master controller & motherboard includes a master controller, master controller motherboard, ES Net NIC, and ES-PS power supply:

- The master controller mounts in slot 4 of a two slot motherboard (slots 3 and 4 of the master controller bay) and provides one RUI+ communications channel (Class B or Class A), available at slot 4. An ES Net network interface card is mounted in slot 3.
- The NDU bay RUI+ communications output (configurable for isolated or un-isolated operation) supports up to 31 devices per master controller at up to 2500 ft (762 m) for single run, or 10,000 ft (3048 m) total if wiring is Class B and T-tapped. If more distance is required, up to four total RUI channels are supported per master controller (up to three 4100-1291 RUI expansion modules may be added). 4100-1291 provides un-isolated RUI communications.
- Both the NDU master controller RUI+ output and RUI expansion modules support the following remote LCD annunciators: 4603-9100 series LCD annunciators and 4100-9400 series remote InfoAlarm command centers, 4100 series 24 I/O and LED/switch modules and 4602 series status command units (SCU), remote command units (RCU) and graphic I/O modules (4602 series equipment requires un-isolated output).
- ES power supply (ES-PS) is rated for 9.5 A total, 12.7 A when using optional fan module 4100-5131; includes battery charger, one 2 A aux power output, 2 block spaces for compatible optional modules and provisions for either an optional City Connect Module or an optional Alarm Relay Module (**Note:** City Connect or Alarm Relay module requires one available block space, refer to data sheet S4100-1031 for additional details).
- Battery charger is dual rate, temperature compensated, and charges up to 50 Ah sealed lead-acid batteries mounted in the battery compartment (33 Ah for single bay cabinets); also is UL and ULC listed for charging up to 110 Ah batteries mounted in an external cabinet (refer to data sheet S2081-0012 for details)
- Battery and charger monitoring includes battery charger status and low or depleted battery conditions; status information provided to the master controller includes analog values for: battery voltage, charger voltage and current, actual system voltage and current, and individual IDNAC SLC currents
- Low battery cutout is selectable for each ES-PS power supply
- Outputs are power-limited, except for the battery charger and city circuits

Note: ES-PS aux relay is disabled in the NDU bay.

ES-PS power supply mounted optional modules (select one):

- **City Connect Module** (4100-6031, with disconnect switches, or 4100-6032, without disconnect switches) can be selected for conventional dual circuit city connections (requires 1 block space)
- **Alarm Relay Module** (4100-6033) provides three Form C relays that are used for Alarm, Trouble, and Supervisory, rated 2 A resistive @ 32 VDC (requires 1 block space)

VCC (expansion bay) includes a master controller, master controller motherboard, ES Net NIC and ES-PS power supply:

- The master controller mounts in slot 4 of a two slot motherboard (slots 3 and 4 of the master controller bay) and provides one RUI+ communications channel (Class B or Class A), available at slot 4. An ES Net network interface card is mounted in Slot 3.
- The VCC bay RUI+ communications output (configurable for isolated or un-isolated operation) supports up to 31 devices per master controller at up to 2500 ft (762 m) for single run, or 10,000 ft (3048 m) total if wiring is Class B and T-tapped. If more distance is required, up to four total RUI channels are supported per master controller (up to three 4100-1291 RUI expansion modules may be added). 4100-1291 provides un-isolated RUI communications.
- Both the VCC master controller RUI+ output and RUI expansion modules are compatible with the following equipment: miniplex transponders, 4603-9100 series LCD annunciators, 4100-9400 series remote InfoAlarm command centers, 4100 series 24 I/O and LED/switch modules and 4602 series status command units (SCU), remote command units (RCU) and graphic I/O modules (4602 series equipment requires un-isolated output).
- ES power supply (ES-PS) is rated for 9.5 A total (up to 12.7A when using optional fan module 4100-5131); includes battery charger, one 2 A output configurable for auxiliary power or simple NAC operation, 2 block spaces for compatible optional modules and provisions for either an optional City Connect Module or an optional Alarm Relay Module (**Note:** City Connect or Alarm Relay module requires one available block space, refer to data sheet S4100-1031 for additional details).
- Battery charger is dual rate, temperature compensated, and charges up to 50 Ah sealed lead-acid batteries mounted in the battery compartment (33 Ah for single bay cabinets); also is UL and ULC listed for charging up to 110 Ah batteries mounted in an external cabinet (see data sheet S2081-0012 for details)
- Battery and charger monitoring includes battery charger status and low or depleted battery conditions; status information provided to the master controller includes analog values for: battery voltage, charger voltage and current, actual system voltage and current, and individual IDNAC SLC currents
- Low battery cutout is selectable for each ES-PS power supply
- Outputs are power-limited, except for the battery charger and city circuits

2 A Programmable Output:

- Select for conventional NAC operation to provide supervised reverse polarity for sounder base power, suppression release peripheral (SRP) power, and other coded NAC operation requirements
- Select for auxiliary (AUX) operation for sounder base power, four-wire detector power, or door holder; supervised AUX operation does not require an end-of-line relay to provide power-limited operation

ES-PS Power Supply Mounted Optional Modules (select one):

- **City Connect Module** (4100-6031, with disconnect switches, or 4100-6032, without disconnect switches) can be selected for conventional dual circuit city connections (requires 1 block space)
- **Alarm Relay Module** (4100-6033) provides three Form C relays that are used for Alarm, Trouble, and Supervisory, rated 2 A resistive @ 32 VDC (requires 1 block space)

NDU and NDU VCC Panel Selection

Table 2: Network Display Unit, Non-Voice

| Model | Input Power | Includes | Listing | Supv. | Alarm |
|-----------|----------------|--|--------------|--------|--------|
| 4100-9750 | 120 to 240 VAC | NDU Master Controller Bay with English 2x40 Display, CPU Card, ES Network Interface Card, ES Power Supply (120 V to 240 V 50/60 Hz, 24 V Aux. Relay, 24 V Aux. Power Tap, 110 Ah Battery Charger) and external RUI+ (isolated or un-isolated) communications interface See Media Card Selection for NDU and NDU VCC ES Net Network Interface Cards for selected Network Media Card current | UL/ULC | 397 mA | 441 mA |
| 4100-9751 | | Same as 4100-9750 except with Canadian French user interface | ULC | | |
| 4100-9752 | | Same as 4100-9750 except with English InfoAlarm user interface with raised keys | UL/ULC | | |
| 4100-9753 | | Same as 4100-9750 except with Canadian French InfoAlarm user interface with raised keys | ULC | 469 mA | 511 mA |
| 4100-9754 | | Same as 4100-9750 except with InfoAlarm user interface with flat keys and slide in labels | UL/ULC | | |
| 4100-9755 | | Same as 4100-9750 except with Color ES Touch Screen Display | UL/ULC, CSFM | 482 mA | 561 mA |

Table 3: Network Display Unit with Voice Command Center (VCC)

| Model | Input Power | Includes | Listing | Supv. | Alarm |
|-----------|----------------|--|--------------|--------|--------|
| 4100-9760 | 120 to 240 VAC | NDU Master Controller Bay with English 2x40 Display, CPU Card, ES Network Interface Card, ES Power Supply (120 V to 240 V 50/60 Hz, 24 V Aux. Relay, 24 V Aux. Power Tap, 110 Ah Battery Charger) and external RUI+ (isolated or un-isolated) communications interface VCC Master Controller Bay with CPU Card, ES Network Interface Card, IDNet 2 Card supports up to 250 addressable/analog points, ES Power Supply (120 V to 240 V 50/60 Hz, 24 V Aux. Relay, 24 V Aux. Power Tap, 110 Ah Battery Charger) and external RUI+ (isolated or un-isolated) communications interface See Media Card Selection for NDU and NDU VCC ES Net Network Interface Cards for selected Network Media Card current | UL/ULC | 784 mA | 837 mA |
| 4100-9761 | | Same as 4100-9760 except with Canadian French user interface in NDU Master Controller Bay | ULC | | |
| 4100-9762 | | Same as 4100-9760 except with English InfoAlarm user interface with raised keys in NDU Master Controller Bay | UL/ULC | | |
| 4100-9763 | | Same as 4100-9760 except with Canadian French InfoAlarm user interface with raised keys in NDU Master Controller Bay | ULC | 856 mA | 907 mA |
| 4100-9764 | | Same as 4100-9760 except with InfoAlarm user interface with flat keys and slide in labels in NDU Master Controller Bay | UL/ULC | | |
| 4100-9765 | | Same as 4100-9760 except with Color ES Touch Screen Display | UL/ULC, CSFM | 869 mA | 957 mA |

Note:

1. See [NDU Equipment Selection](#) and [VCC Equipment Selection](#) for compatible NDU and VCC equipment options
2. See [Standard Module Details](#) for additional system power supply information.
3. ES Net media card current is listed separately, see relevant media specifications for more details.
4. For additional information on ES Net products and specifications refer to data sheet S4100-0076.
5. For additional information on InfoAlarm Command Center expanded content displays refer to data sheet S4100-1045.
6. For panels listed in Table 3, order audio modules separately as required.

Media Card Selection for NDU and NDU VCC ES Net Network Interface Cards

Table 4: ES Net dual channel media cards for 4100ES mounted NICs

| Model | Description | Size | Alarm/Supv. |
|-----------|--|------|-------------|
| 4100-6308 | ES Net NIC dual channel single-mode fiber media card | N/A | 135 mA |
| 4100-6309 | ES Net NIC dual channel multi-mode fiber media card | N/A | 135 mA |
| 4100-6307 | ES Net NIC dual channel DSL media card | N/A | 155 mA |

Notes:

- Order fiber media service kits for retrofit jobs where ST connectors are already installed. See [Fiber media card service kits](#) for additional information.
- For additional information on ES Net fire alarm products and specifications, refer to data sheet [S4100-0076](#).

Fiber media card service kits

Table 5: ES Net fiber media card service kits

| Model | Fiber type | Description |
|-----------|-----------------------------|--|
| 4100-6412 | 50/125 μ m multi-mode | For use in retrofit jobs where fiber optic cables with ST connectors are already installed. Includes one ST to SC 18 in. (45.7 cm) fiber optic patch cord, one ST-ST coupler, one wire clamp, and one insulating sleeve. |
| 4100-6413 | 62.5/125 μ m multi-mode | |
| 4100-6414 | 9/125 μ m single-mode | |

Note: Fiber optic media cards must be of the same type on each end of the fiber link. When replacing a media card with a different type, the card on the other end of the link must be replaced with a fiber optic media card of the same type.

NDU Equipment Selection

The NDU functions as a special purpose master controller dedicated to providing annunciation of up to 12,000 network points. The following information provides equipment selection for the basic Network Display Unit (NDU). All features for the NDU are also applicable to the VCC. The primary product data sheets for NDU equipment are S4100-1031 Basic Panel Equipment and S4100-0076 ES Net Network Products and Specifications.

Table 6: NDU Equipment Selection

| Model | Description | Size | Supv. | Alarm |
|-----------|---|---------|--------|--------|
| 4100-1291 | Remote Unit Interface module (RUI); up to three maximum per control panel | 1 Slot | 85 mA | 85 mA |
| 4100-6031 | Select one per ES Power Supply (non power-limited) City Circuit, with disconnect switches | 1 Block | 20 mA | 36 mA |
| 4100-6032 | | | 20 mA | 36 mA |
| 4100-6033 | | | 15 mA | 37 mA |
| 4100-6038 | Dual RS-232 Interface; three maximum; can mount in Slot 3 or Slot 2 of Master Controller | 1 Slot | 132 mA | 132 mA |
| 4100-6046 | Dual Port RS-232 standard interface (4 x 5 module) | 1 Block | 60 mA | 60 mA |
| 4100-6080 | Side Mount DACT, Point or Event Reporting; one shipped unless 4100-7908 is selected; two max. per system; includes two 2080-9047 cables, 14 ft (4.3 m) long, RJ45 plug and spade lugs | 1 Slot | 30 mA | 40 mA |
| 4100-9816 | Master Clock Interface Module with one standard RS-232 port (see S4100-0033) | 1 Slot | 132 mA | 132 mA |
| 4100-6079 | Safelinc internet interface module | 2 Slots | 145 mA | 145 mA |
| 4100-1290 | 24 Point I/O Module | 1 Slot | 34 mA | 75 mA |
| 4100-6069 | BACpac Ethernet Module – 1500 Points | 1 Slot | 123 mA | 123 mA |
| 4100-6110 | BACpac Ethernet Module – 5,000 Points | 1 Slot | 123 mA | 123 mA |
| 4100-6111 | BACpac Ethernet Module – 15,000 Points | 1 Slot | 123 mA | 123 mA |
| 4100-6101 | Physical Bridge Module Class B | 1 Slot | 210 mA | 210 mA |
| 4100-6102 | Physical Bridge Module Class X | 2 Slots | 300 mA | 300 mA |

Table 6: NDU Equipment Selection

| Model | Description | | Size | Supv. | Alarm |
|-----------|--|--|------|--------|--------|
| 4100-6308 | ES Net NIC dual channel single-mode fiber media card | Select per network connection requirements; mounts on the supplied ES Net NIC; up to two media cards per slot type and flat type NIC. Dual Channel Media Cards provide two ports for input and output connections. Field connections require proper port pairing, refer to <i>579-1258 ES Net Dual Channel Fiber, Ethernet, and DSL Media Card Installation Instructions</i> for additional information. | N.A | 135 mA | 135 mA |
| 4100-6309 | ES Net NIC dual channel multi-mode fiber media card | | N.A | 155 mA | 155 mA |
| 4100-6307 | ES Net NIC dual channel DSL media card | | N.A | 135 mA | 135 mA |

Table 7: ES Power Supplies

| Model | Voltage | Description | Includes | Provides Power to Bay | Size | Supv. | Alarm |
|-----------|-----------------------|-------------|--|-----------------------|----------|-------|-------|
| 4100-5401 | 120 to 240 V 50/60 Hz | ES-PS | 24 V Aux. Relay, 24 V Aux. Power 2 A Tap/ Simple NAC, 110 Ah Battery Charger, 2 PDI Blocks for option cards. | Yes | 2 Blocks | 68 mA | 77 mA |
| 4100-5402 | 120 to 240 V 50/60 Hz | ES-XPS | Same as ES-PS above except without battery charger. | No | | | |

Table 8: Power supply accessories

| Model | Description | Size | Current |
|-----------|---|--|--|
| 4100-5152 | 12 VDC Power Option, 2 A maximum | 1 Block | 1.5 A maximum |
| 4100-0156 | 8 VDC Converter, required for multiple Physical Bridge Modules, 3 A maximum | 1 Block | included with loads |
| 4100-5130 | Voltage Regulator Module, 22.8 to 26.4 VDC (25 VDC nominal); isolated and resettable output; includes earth detection circuit and trouble relay for status monitoring. | 1 Block | 3 A maximum with 2.5 A load, 4.9 A maximum with 4 A load |
| 4100-5131 | ES-PS Fan Module, allows more than one power supply to be installed in a single bay and may increase total DC output power capacity per power supply. See Table 9 for specifications. | N/A | 0 mA Supv. 200 mA Alarm |
| 4100-0636 | Box Interconnection Harness Kit (non-audio); order one for each close-nippled cabinet | | |
| 4100-0638 | 4100 Slot Module Additional 24 VDC Harness; needed when 4100 Slot module requirements exceed 2 A from ES-PS | | |
| 4100-5403 | Harness for ES-PS Backup Power Supply | | |
| 4100-0644 | 120 VAC PDM Harness | 1 PDM harness is required per power supply, select as required for appropriate input voltage | |
| 4100-0645 | 220 VAC PDM Harness | | |
| 4100-0646 | 230 VAC PDM Harness | | |
| 4100-0647 | 240 VAC PDM Harness | | |

General Specifications

Table 9: ES Power Supply Specifications (ES-PS and ES-XPS)

| Specifications | Rating |
|--|--|
| AC Input Power | 120 to 240 VAC |
| 120 VAC | 3.72 A |
| 220 to 240 VAC | 1.82 A |
| Total DC Output Power Capacity | |
| Without Fan | 9.5 A |
| With 4100-5131 Fan and 4100-5451 IDNAC Modules | 9.7 A |
| With 4100-5131 Fan (without 4100-5451 IDNAC Module) | 12.7 A |
| With Regulated 24V Appliance Loads (with or without 4100-5131 Fan) | 5.0 A |
| Special Application Appliance Loads: supports full total DC output power capacity ratings above | Simplex horns, strobes, and combination horn/strobes and speaker/strobes (contact your Simplex product representative for compatible appliances) |
| Regulated 24V Appliances: reduces total DC output power capacity to 5.0 A | Power for other UL listed appliances; use associated external synchronization modules where required |
| Auxiliary Power Tap | 2 A maximum (taken from total output power capacity) |
| NACs Programmed for Auxiliary Power | 3 A maximum per NAC, 5 A maximum total (taken from total output power capacity) |
| Battery Charger (ES-PS only) | Sealed Lead-Acid Batteries |
| Battery Ah Capacity | UL/ULC listed for battery charging of up to 110 Ah (batteries larger than 50 Ah require a remote battery cabinet) |
| Charger characteristics and performance | Temperature compensated, dual rate, recharges depleted batteries within 48 hours |
| Environmental | |
| Operating Temperature | 32°F to 120°F (0°C to 49°C) |
| Operating Humidity | Up to 93% RH, non-condensing @ 90°F (32°C) maximum |
| Option Card Mounting | Two vertical blocks are available for compatible modules (refer to 579-1288 installation instructions for additional details) |

Note:

1. Battery charger is only available on the ES-PS power supply.
2. When an ES-PS is used to power Flex-35 or Flex-50 Amplifiers, the ES-PS battery charger is not available.

VCC Equipment Selection

The Voice Command Center (VCC) is a separate network node mounted within the same cabinet as the NDU. The VCC has the full capability of a 4100ES fire alarm control unit including the ability to operate as the Network Voice Command Center. While the NDU has a limited equipment selection, equipment selection for the VCC includes all the features supported by 4100ES fire alarm control units. Please refer to the 4100ES and ES Net Product Data Sheets referenced below for VCC equipment selection information.

Note: The primary data sheet references for VCC equipment selection are:

- S4100-1034: Emergency Voice/Alarm Equipment
- S4100-0032: LED/Switch Modules & Printer
- S4100-1031: Basic Panel Equipment
- S4100-0076: ES Net Network Products and Specifications

Table 10: Additional 4100ES and ES Net data sheet reference

| Subject | Data Sheet |
|--|------------|
| Serial DACT (SDACT) for 4100ES, 4010ES, 4007ES | S2080-0009 |
| Battery and Battery Cabinet Reference for 4100ES | S2081-0006 |
| 110 Ah Batteries and Cabinets for 4100ES | S2081-0012 |
| External 110 Ah Battery Charger for 4100ES, 4010ES | S4081-0002 |
| 4100ES LED/Switch Modules & Printer | S4100-0032 |
| 4100ES Enclosures | S4100-0037 |
| BACpac Ethernet Module | S4100-0051 |
| Building Network Interface Card (BNIC) | S4100-0061 |
| SafeLINC Internet Interface | S4100-0062 |
| 4100ES Basic Panels with ES-PS Power Supplies | S4100-1031 |
| 4100ES Emergency Voice/Alarm Equipment | S4100-1034 |
| ES Net Network Products and Specifications | S4100-1076 |
| TrueSite Workstation | S4190-0016 |
| TrueSite Incident Commander | S4190-0020 |
| Network System Integrator (NSI) | S4190-0026 |

Expansion Bay Module Loading Reference

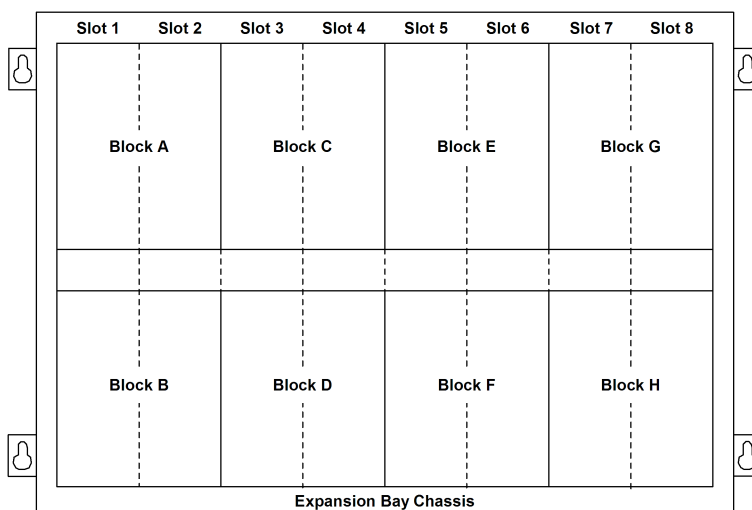

Figure 12: Expansion bay module loading reference

Size Definitions

- Block = 4 in. W x 5.65 in. H (102 mm x 144 mm); (often called 4 x 5 modules)
- Slot = 2 in. W x 8 in. H (51 mm x 203 mm) motherboard with daughter card

Note: Individual module loading (size) specifications are identified in the NDU Product Selection section and the applicable 4100ES and ESNet Product Data Sheets for VCC modules.

Wall Mounted Enclosure Installation Reference

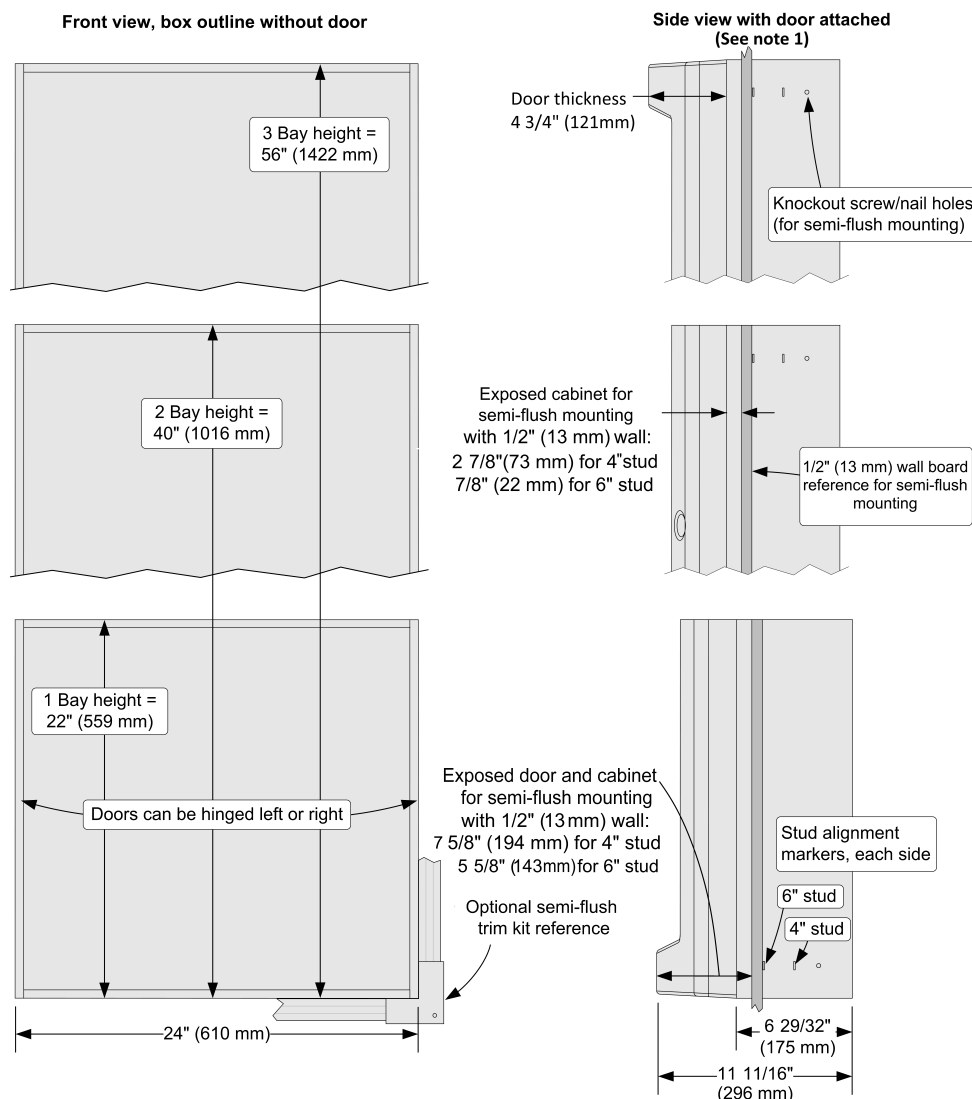

Figure 13: Wall Mount Enclosure

Note:

- Side view dimensions are shown with minimal cabinet and door protrusion from the exterior wall. For 6 in. stud construction with minimum protrusion shown, the door will open 90 degrees. To allow the door to open 180 degrees, the exposed cabinet dimension from the exterior wall must be a minimum of 3 in. (76 mm) for both 4 in. and 6 in. stud construction.
- A system ground must be provided for earth detection and transient protection devices. This connection shall be made to an approved, dedicated earth connection per NFPA 70, article 250, and NFPA 780.